

# ROAD MILLING TOOLS

PAVEMENT MAINTAINING WORK  
(MILLING, PLANING, REGENERATING ,ROAD MIXING)

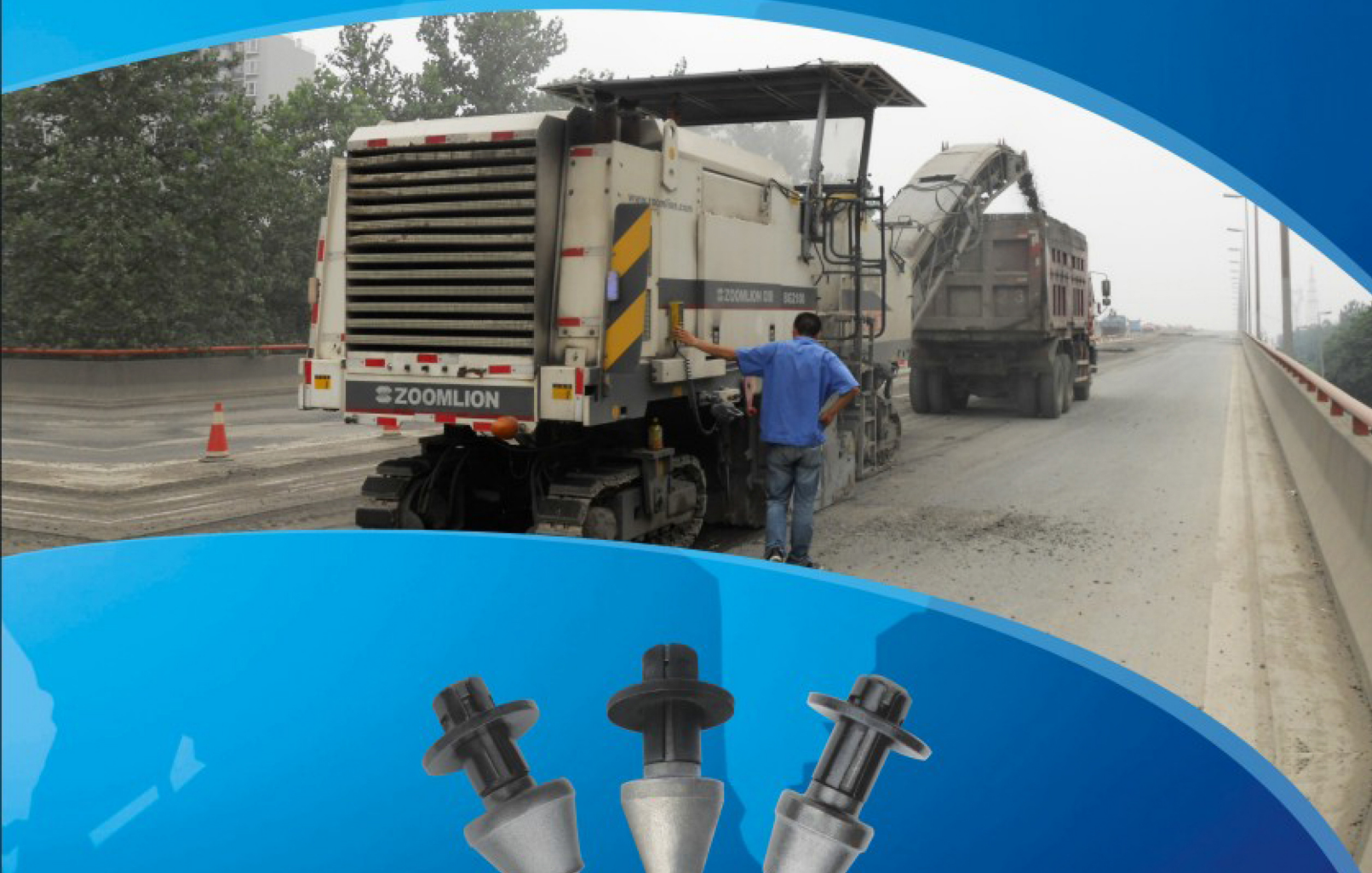

## Road Milling and Planing tools

We pay extreme attention to the whole manufacturing process in order to meet fully the needs of our customers. The cemented carbide is produced with the updated technological process in order to give fully consideration to the requirements of both the optimal strength and brazing property. The special brazing and heat treating process ensures the binding strength of the cemented carbide and steel body, as well as the hardness of the steel body so that a more excellent utilization performance can be achieved.

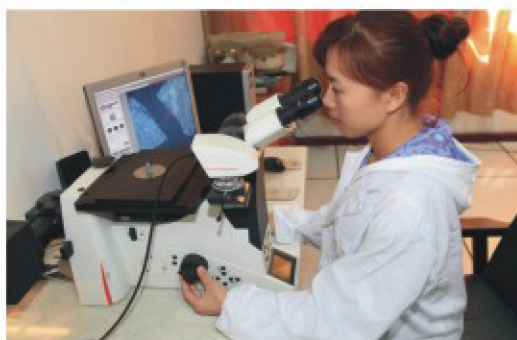

# Catalog

Cemented Carbide	02
Selection guide of carbide bits	03
Influential factors on the road milling and planing work	05
Selection guide of road milling and planing tools	06
HUB serial road milling and planing tools	07
HUZ serial road milling and planing tools	08
HUS serial road milling and planing tools	09
22mm serial road milling and planing tools	09



# Selection Guide of Carbide bits

## ► Buttons with flat bottom

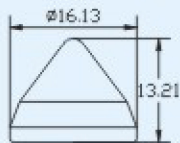

**Equipment:**

Suitable for the middle and small type of equipments

**Road Pavement Condition:**

Asphalt

**Product' s Features:**

Optimal impact and shear resistance

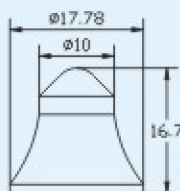

**Equipment:**

Suitable for all type of equipments

**Road Pavement Condition:**

Asphalt and cement pavement

**Product' s Features:**

Maximal penetrating force, the design of the large round angle of the lower section enables clearly to improve the breaking resistance

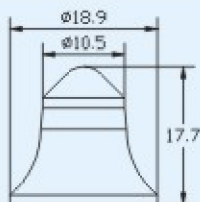

**Equipment:**

Suitable for middle and large type of equipments

**Road Pavement Condition:**

Asphalt and cement pavement

**Product' s Features:**

Extremely optimal penetrating force, and lasting high speed cutting ability

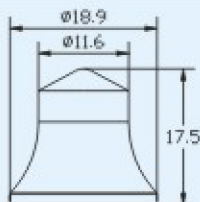

**Equipment:**

Suitable for middle and large type of equipments

**Road Pavement Condition:**

Asphalt and cement pavement

**Product' s Features:**

Extremely optimal impact and shear resistance

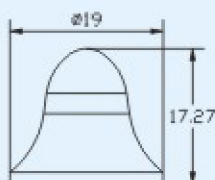

**Equipment:**

Suitable for large type of equipments

**Road Pavement Condition:**

Asphalt pavement

**Product' s Features:**

Extremely optimal impact resistance

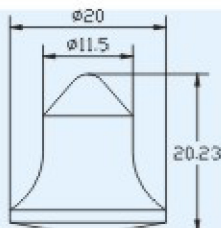

**Equipment:**

Suitable for large type of equipments

**Road Pavement Condition:**

Asphalt pavement

**Product' s Features:**

High effective cutting under the working condition of high abrasion

## ► Cap- form button

Valve socket-wise connection for enhancing the strength and shear resistance

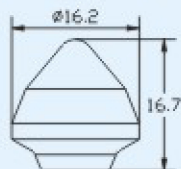

### Equipment:

Suitable for all kinds of road pavement regenerating, milling and planing equipments

### Road pavement condition:

Applicable under different working condition

### Product's Features:

The penetrating effect is not the most important factor. The carbide tip gives the bit-steel body a good protection under different working conditions, the valve socket-wise connection makes an increase of the shear resistance clearly.

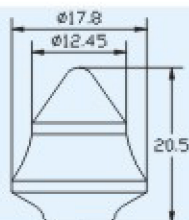

### Equipment:

Suitable for middle and large type of equipments

### Road pavement condition:

Asphalt and cement pavement

### Product's Features:

Valve socket-wise connection makes an increase of the shear resistance clearly.

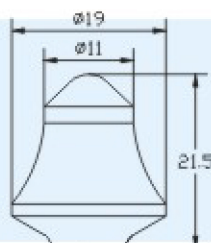

### Equipment:

Suitable for middle and large type of equipments

### Road pavement condition:

Asphalt and cement pavement

### Product's Features:

Valve socket-wise connection makes an increase of the shear resistance clearly. The designed big size is applicable under the working condition of a extreme abrasion.

## ► Column-form button

Buttons for cement pavement coarse-making

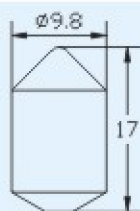

### Equipment:

Suitable for middle and small type of equipments

### Road pavement condition:

Cement pavement

### Product's Features:

This type of buttons has a good shear resistance

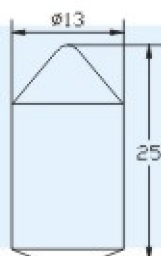
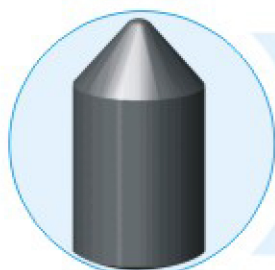

### Equipment:

Suitable for middle and large type of equipment

### Road pavement condition:

Cement pavement

### Product's Features:

The designed big size is applicable under the working condition of a extreme abrasion.

## I Air temperature

The temperature of the outer environment will make an influence on the milling and planing work of a asphalt road pavement. Especially the capability of the milling and planing machine and tools will be taken down up to 40%. The wear of both the carbide button and steel body of tools will occur simultaneously.

## II Equipment's factors of the milling and planing machine

The following factors will cause reducing the effect of the milling and planing machine and tools, and result to a greater wear of the tools.

- The heavy wear of the transport chain plate.
- The speed of the transport chain plate is too low.
- The dip angle of the transport chain plate is too large.
- The heavy wear of the milling and planing drum.
- The heavy wear of the collecting plate and the side guard of the milling and planing drum.
- The heavy wear of the bit socket of the milling and planing tools.
- The water spray tube is stopped and the cooling effect is bad.

## III Working condition

■ Features of the pavement material: The wear character depends on the lump size and the silicide content of material.

■ Shallow milling and planing: The wear of cemented carbide is normally very high.

■ Deep milling and planing: Milling and planing is normally easier, but the wear of tool's steel body is very high.

■ Asphalt concrete pavement: The wear of cemented carbide is very high, at the same time, a button break of bit may occur resulting from a vertical load.

■ Condition of contacting stress: Contacting stress is very high, and the especial compact pavement and clear wheel tracks have influence on the milling and planing effectiveness.

■ Concrete pavement : All of the types and dimensions of equipments and the lump size and the strength of material have influence on selection of types of bit's buttons.

# Selection Guide of Road Milling and Planing

Type		Head diameter ( mm )	Groove	Recommendation of application				Pieces in a box
				Asphalt pavement		Cold Recyclers and Stabilizers	Cement pavement	
				< 1000mm	> 1000 mm			
HUB Type	HUB-01	34		•				50
	HUB-01C	34	•	•				50
	HUB-02	34		•				50
	HUB-02C	34	•	•				50
	HUB-03	34			•			50
	HUB-03C	34	•		•			50
	HUB-04	34			•			50
	HUB-04C	34	•		•			50
	HUB-05	34			•			50
	HUB-05C	34	•		•			50
	HUB-06	34		•				50
	HUB-06C	34	•	•				50
	HUB-07C	34						50
	HUB-08C	34						50
	HUB-09	34						50
	HUB-10C	34						50
HUZ Type	HUZ-01	40		•				50
	HUZ-02	40			•			50
	HUZ-03	40			•			50
	HUZ-04	40			•			50
	HUZ-05	40			•		•	50
	HUZ-05C	40	•		•		•	50
HUS Type	HUS-01	35					•	50
	HUS-02	35					•	50
	HUS-03	32	•				•	50
	HUS-04	33					•	50
22mm	HUB-03/22	37				•		40
	HUB-09/22	37				•		40
	HUS-03/22	37					•	40
	HUS-05/22	37					•	40

# HUB Series

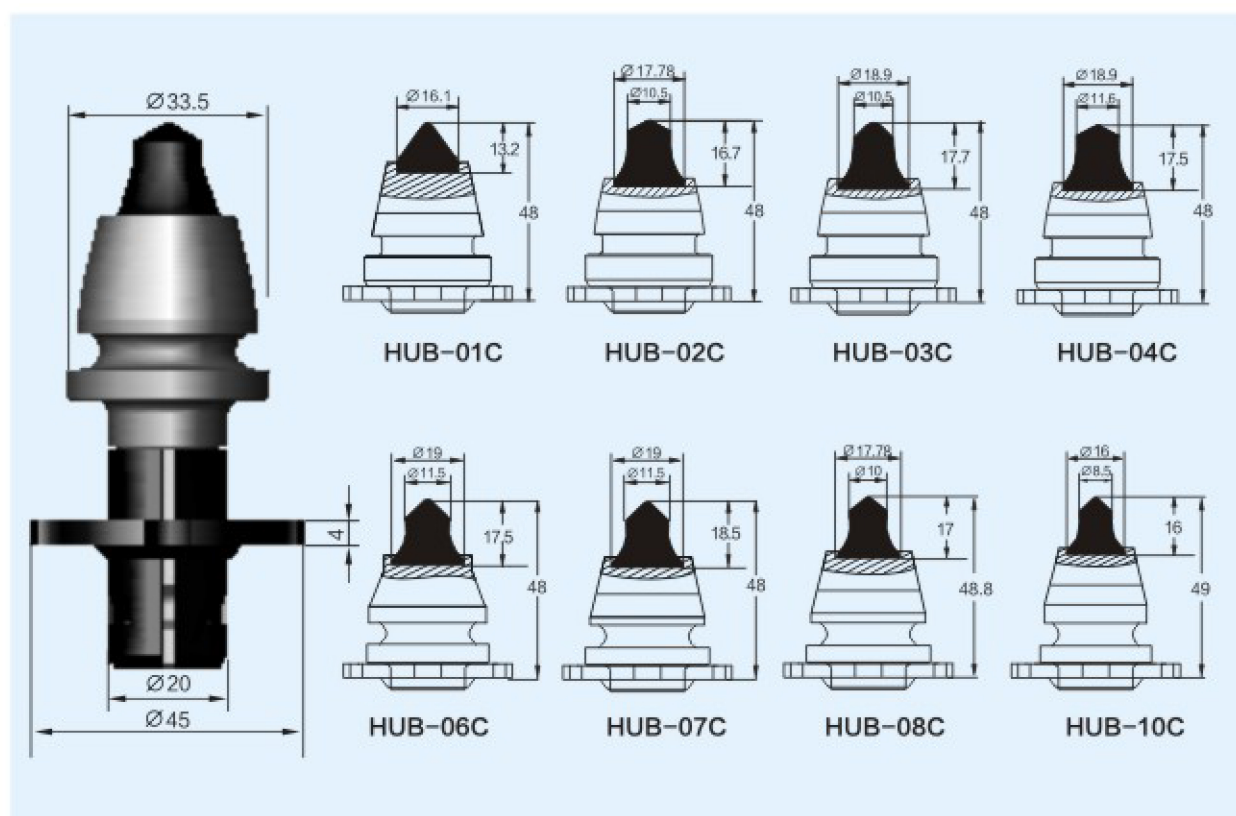
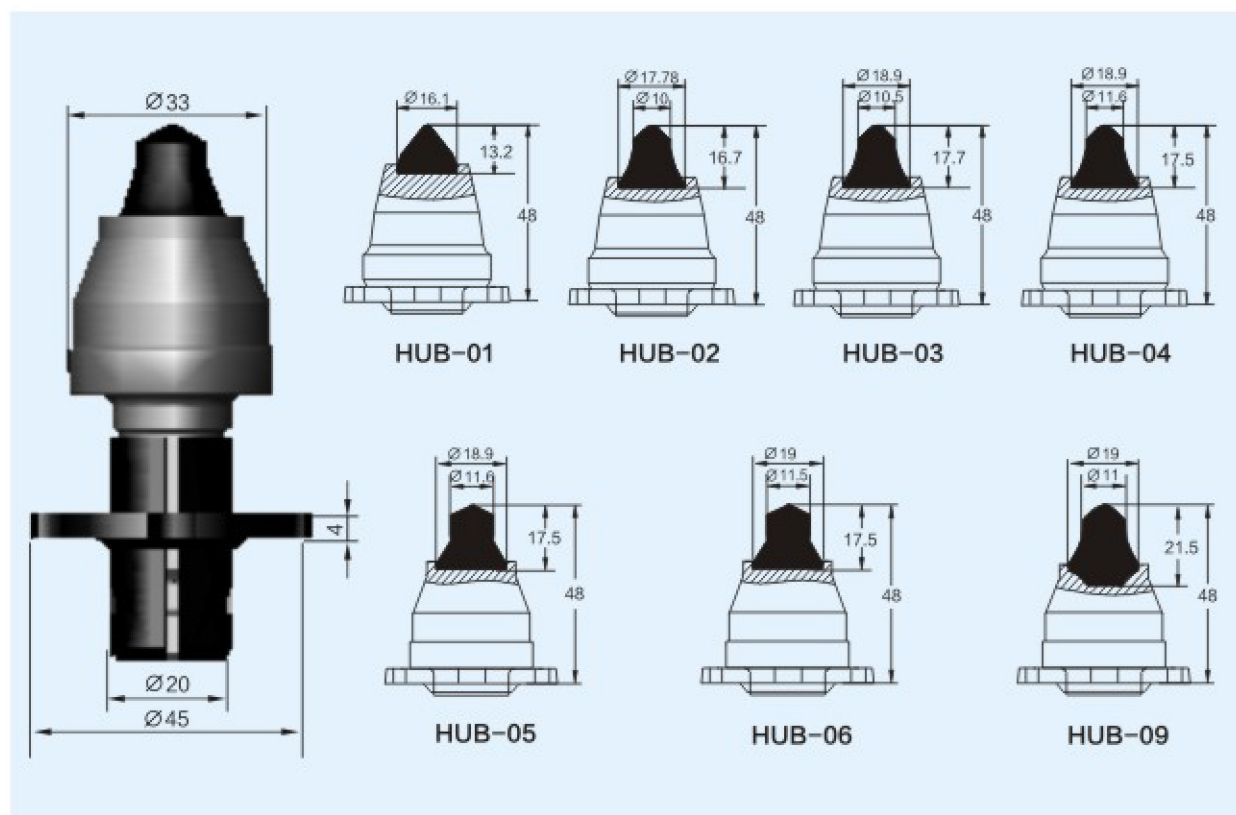

# HUZ Series

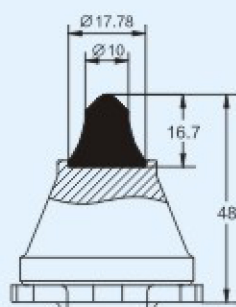
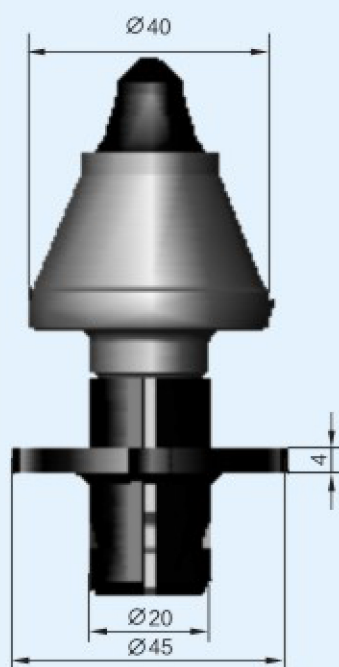

HUZ-01

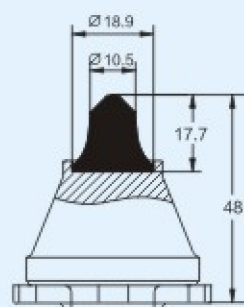

HUZ-02

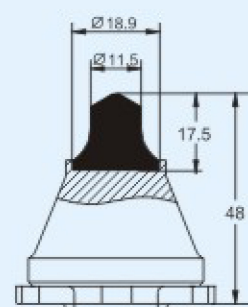

HUZ-03

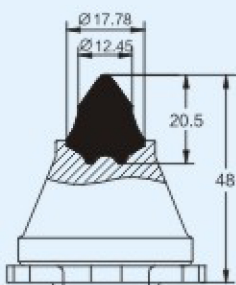
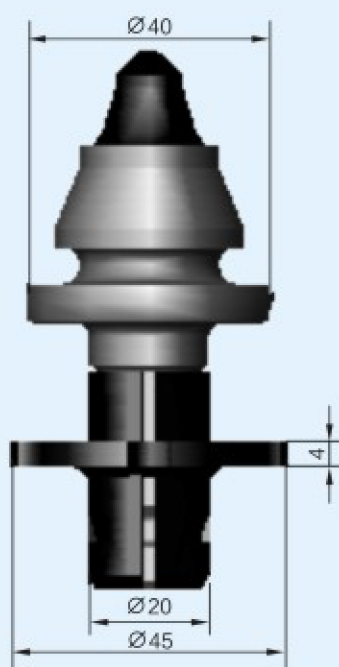

HUZ-04

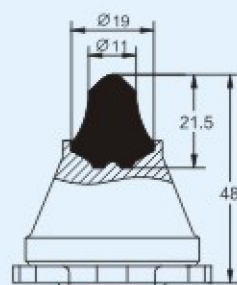

HUZ-05

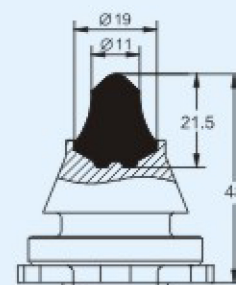

HUZ-05C

# HUS、22mm Series

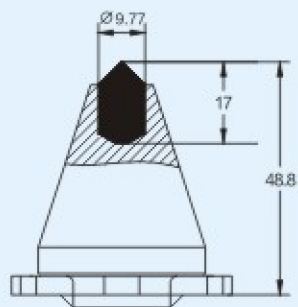
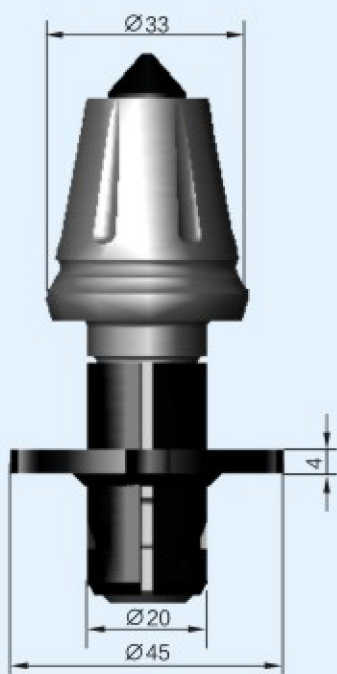

HUS-01

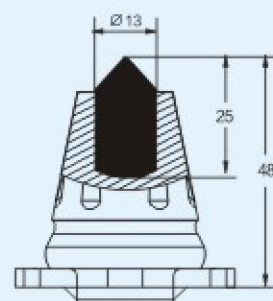

HUS-02

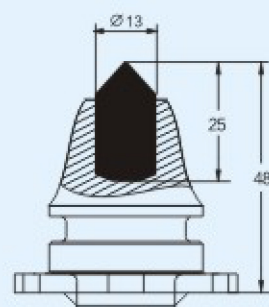

HUS-03

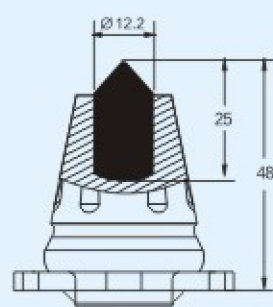

HUS-04

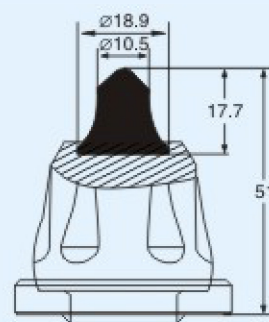
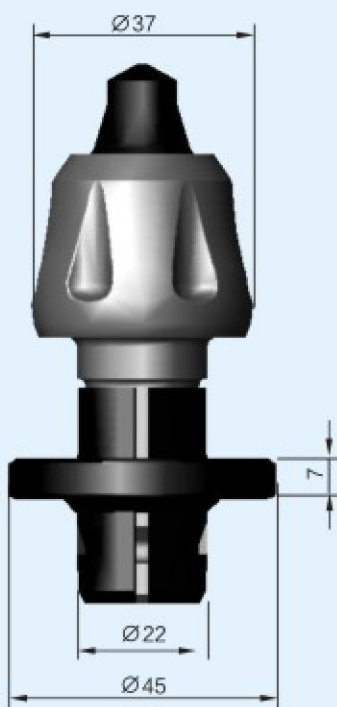

HUB-03/22

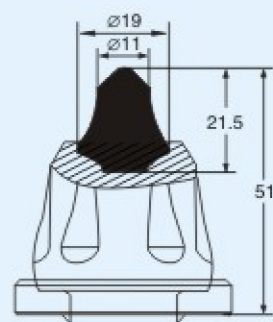

HUB-09/22

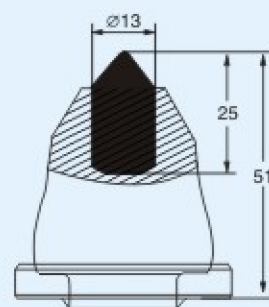

HUS-03/22

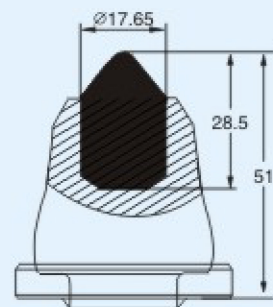

HUS-05/22